

Hortilight LED systems

ScrogMaster Pro 1450

Technical Specification

Release Version: V2.0

Release Date: 2019/12/01

Email: info@hortilight.eu

Address: Postbus 7530, 8903 JM, Leeuwarden, The Netherlands

Main advantages ScrogMaster Pro

1. High efficiency and Energy saving

The ScrogMaster Pro is a high efficiency LED grow light. Tests have shown that LED grow lights give plants greater light intensity and grow rates than standard HPS grow lights, yet using only 30% to 50% of the electricity.

2. Long lifespan

The LEDs used for the ScrogMaster Pro are Samsung's Horticulture Series LEDs. The Samsung LEDs are especially developed for Horticulture environment, which ensures the LEDs are resilient against severe temperature, humidity and exposure to chemicals. This guarantees high light-output, high quality and high reliability with a long lifespan up to 35.000 hours (> 50.000 hours under lab conditions).

3. Setup required

The ScrogMaster Pro requires a simple setup. The LED Bars need to be assembled to the middle LED driver unit. After connecting the LED Bars, the ScrogMaster Pro can be plugged directly into AC100 to AC277 Volts power socket.

4. Waterproof

The LED Drivers, LED Bars and wire connectors are IP65 waterproof. The LEDs are attached to the aluminum frame and waterproof sealed by a patented reflector.

5. SSP technology and electrical protection

The ScrogMaster Pro uses SSP technology. SSP technology restricts the DC output voltage to never be higher than the LED chips voltage. It avoids the LEDs from higher voltage shocking. The power design is also lighting- and surge-proof.

6. SPC technology for excellent performance

SPC technology guarantees the LED bars are more stable. If any of the LED chips does fault, it will not affect other LEDs, as it does with standard LED grow lights. The high quality SSP and SPC design makes the ScrogMaster Pro solid and safe.

7. Advanced thermal design

The LEDs are passively cooled by the aluminum frame of the LED Bars. The aluminum PCB is directly attached to the aluminum body of the LED Bars for excellent heat dissipation. Passive LED cooling is preferred above active cooling. No moving parts are needed, which is energy efficient and requires no maintenance.

8. Powerful full spectrum

The ScrogMaster Pro is provided with Samsung's high-class Series Horticulture LEDs which have industry leading PPF per Watt. The LEDs are waterproof sealed by a patented reflector and not covered by glass, which does improve the efficiency by 10%. This is why the ScrogMaster Pro does have an efficiency of over 2,6 $\mu\text{mol/J}$!

9. Environment friendly

The ScrogMaster Pro doesn't contain the harmful substance HPS & MH have; no hazardous waste to deal with which makes our earth cleaner and greener. LEDs are superior in comparison to other lighting technologies in terms of negative environmental and health effects during the manufacturing process. Producing LEDs consumes far less energy than manufacturing other lighting and it was noted the LEDs contain no mercury and few if any toxins such as iodine and lead.

Features & options ScrogMaster Pro

Bluetooth Timer + dimmer on App

Group control for over 500 fixtures

Control panel box

Button: Timer + dimmer for single fixture

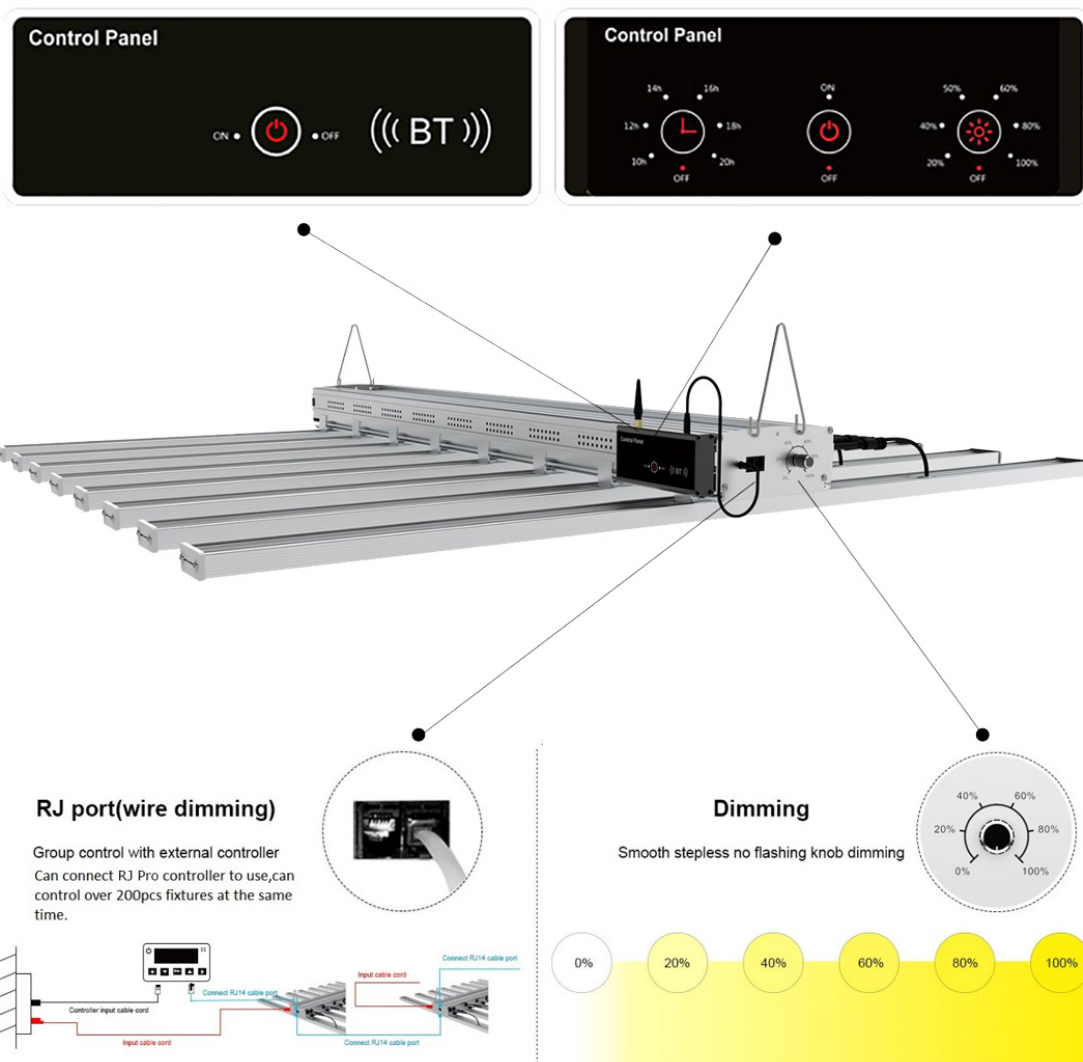

Spectrum ScrogMaster Pro

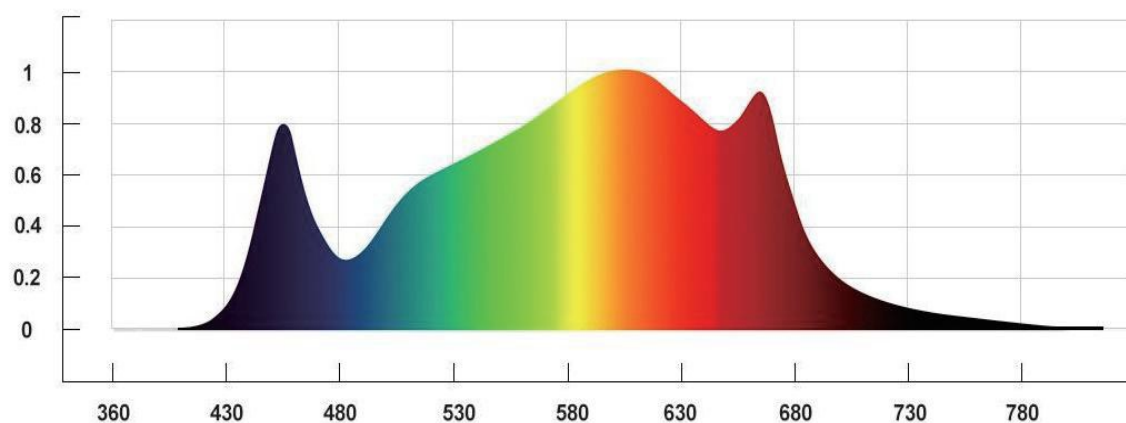

Picture ScrogMaster Pro 1450

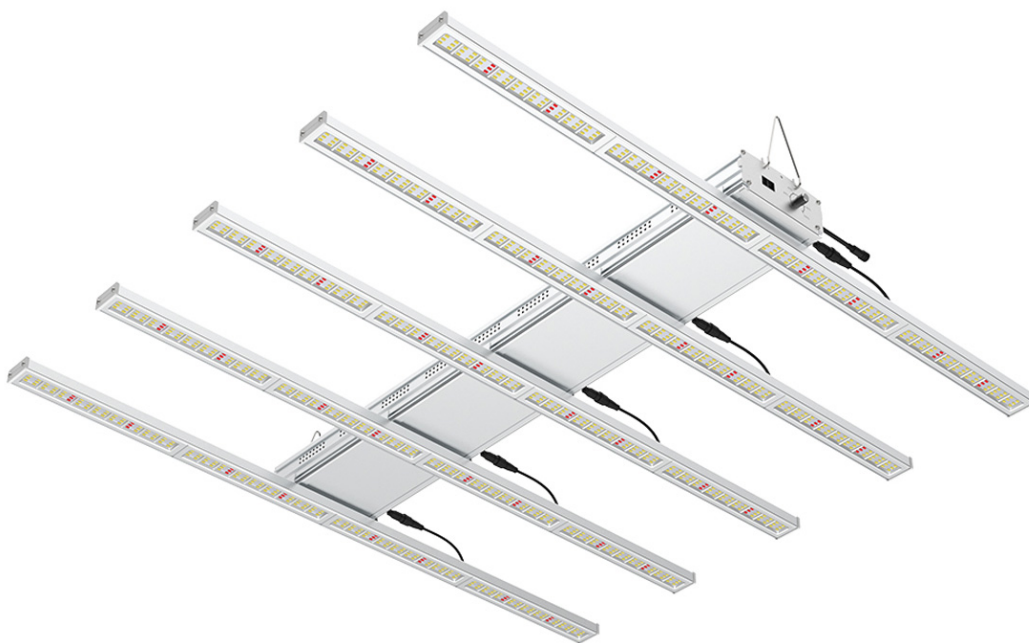

Technical specification SMP1450

Item	Value	Item	Value
Led diodes	Samsung Horticulture	Led value	648 Watt
Led bars	5 pieces	Power factor	> 95%
Led wavelength	Full-spectrum	Power consumption	~ 400 Watt
Light distribution	120° beam angle	Dim control	0 – 100%
Lifespan	> 5 years	Voltage AC	100V – 277V
Height above plants	> 10cm optimal 15cm	Work frequency	50Hz / 60Hz
Lighting area	1,30 to 2,00 m2	Working environment	-20 ~ + 40°C
PAR Photon flux	2,6 µmol / J	Waterproof level	IP65
ScrogMaster size	119*107*11 cm	Weight	14 Kg

Certification and Warranty of ScrogMaster Pro



Note:

1. Select different lighting time depending on plant species.
2. Don't look into the LED light directly without wearing sunglasses.
3. Power socket should be connected to the ground/earth.
4. The ScrogMaster Pro is CE, DLC, ETL and RoHS compliant.
5. Good after sales service; 3 years warranty.